

# VEEV

User guide

**VEEV kit**

# Getting Started

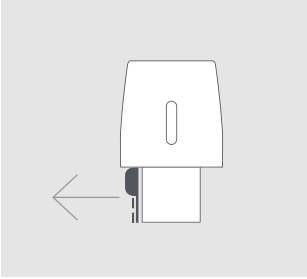

## PREPARE

Remove the seal tab before using the VEEV pod.

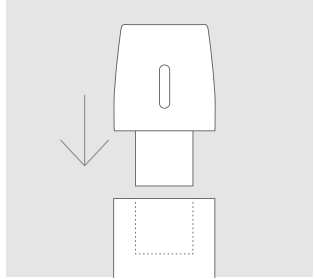

## INSERT

Insert the VEEV pod into your VEEV device. A quick vibration and light pulse will confirm the VEEV pod is correctly inserted.

## VEEV

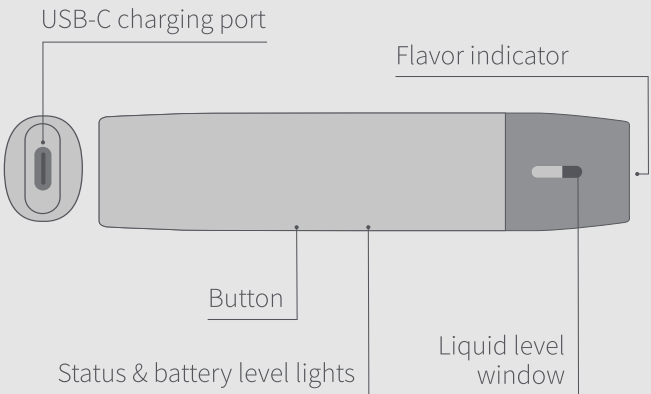

# How to Use

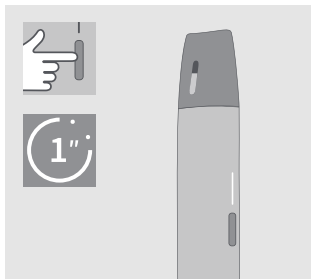

## VAPE

Press the button for 1 second to turn on the device for first use. Once the lights stop pulsing, they will become constant white and show the battery level. You can start vaping.

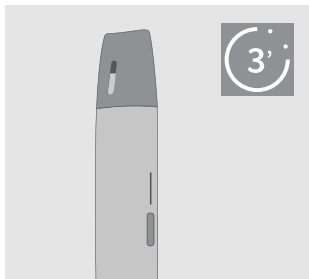

## TURN OFF

If you don't use your VEEV device, it will automatically turn off after 3 minutes to save battery. Alternatively, you can turn off your VEEV device by pressing the button for 1 second until it vibrates and the lights turn off.

Seal tab  
(to be removed)

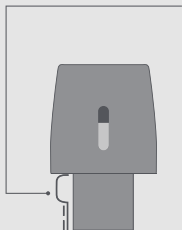

VEEV pod  
(sold separately)

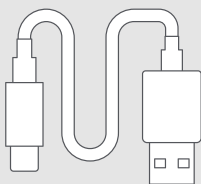

Charging cable\*

Use only a dry cloth to clean the mouth end of device.

\* For optimal charging performance, only use a manufacturer-approved AC power adaptor (sold separately)

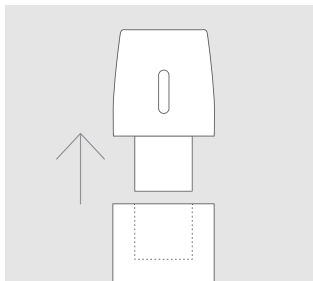

### CHANGE VEEV pod

You don't need to turn off your VEEV device before removing the VEEV pod. When you insert it, a pulsing light might appear to indicate that it is initializing. It is ready to use when the light stops pulsing.

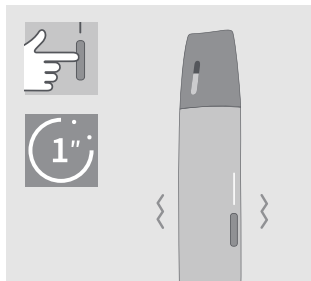

If you wait more than 3 minutes to insert the VEEV pod, your VEEV device will automatically switch off to save battery. You will need to press the button for 1 second after inserting the VEEV pod to start vaping.

### CUSTOMER CARE

For the full user guide, customer care and extended support services, visit [veev-vape.com](http://veev-vape.com)

### ENGAGE WITH VEEV

Download VEEV app on Google Play or on [veev-vape.com](http://veev-vape.com) to access additional features.



\* Google Play and the Google Play Logo are trademarks of Google LLC.

\* VEEV app may not be available in your country.

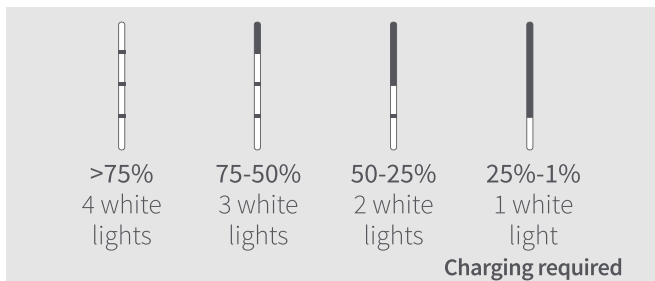

## BATTERY LEVELS

White lights show the battery level. When VEEV battery is empty, the lower white light will blink for a few seconds before turning off.

# Quick Tips

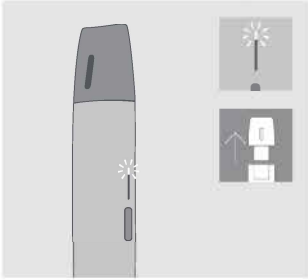

## LOW LIQUID DETECTION

VEEV device will show the upper white light blinking for a few seconds before turning off. This is designed to prevent overheating and burnt taste. Replace the VEEV pod when this happens.

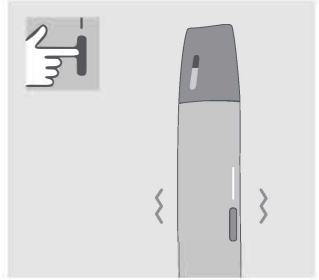

## TO TURN ON & OFF SENSORIAL MODE

The responsive enhances the sensorial experience through a subtle vibration while puffing. Quickly press on the button while taking a puff to turn it on or off.

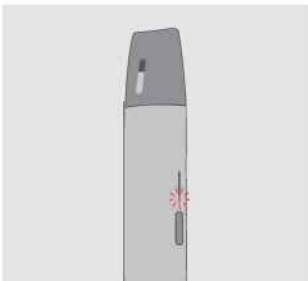

## ERROR NOTIFICATION

VEEV device will show a red light blinking for a few seconds. Try to change the VEEV pod. If this happens again, perform a reset.

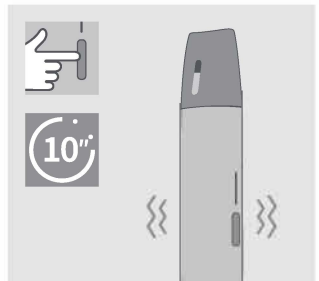

**TO RESET** - Press the button for approximately 10 seconds and release. A few vibrations and blinkings of the lights will confirm the reset of your VEEV device.

# VEEV



This symbol indicates that caution is required when operating the product.

ENGLISH

## SAFETY WARNINGS AND INSTRUCTIONS

**PLEASE READ ALL SAFETY INFORMATION AND INSTRUCTIONS BEFORE USE TO AVOID INJURY.**

**KEEP THESE INSTRUCTIONS FOR FUTURE REFERENCE AS THEY CONTAIN IMPORTANT SAFETY INFORMATION.**

### **I**ntended users

- VEEV device and VEEV pods are for adult use only.
- VEEV device and VEEV pods are for current adult e-cigarette users and smokers who would otherwise continue to use tobacco or nicotine-containing products.
- Children and adolescents should never use VEEV device or VEEV pods under any circumstances.
- VEEV device or VEEV pods should not be used by persons with reduced physical, sensory or mental capabilities.

### **Nicotine**

- VEEV pods contain nicotine, which is addictive.
- VEEV device and VEEV pods are not risk-free. The best way to reduce nicotine-related health risks is to quit tobacco and nicotine use altogether.
- Some consumers of VEEV reported experiencing (in alphabetical order) abdominal pain, cough dizziness, dry mouth, headache, malaise, nasal stuffiness, nausea, mouth irritation, throat irritation, vomiting.
- Nicotine-containing products should not be used by people who have or are at risk of heart disease, are diabetic, are epileptic or are experiencing seizures.
- Nicotine-containing products should not be used during pregnancy or while breast-feeding. If you are pregnant, breast-feeding, or think you may be pregnant you should quit tobacco and nicotine use altogether.
- Stopping smoking or switching to VEEV device and VEEV pods or other nicotine-containing products may require the adjustment of the dosing of certain medicines (e.g. theophylline, clozapine, ropinirole).
- If you have questions about whether you should use VEEV device or VEEV pods given an existing health condition, you should consult a health care professional.

## **⚠ IMPORTANT SAFETY INFORMATION**

### **⚠ WARNING** Choking and ingestion hazard

- Keep VEEV device and VEEV pods out of reach of children and pets at all times.
- CHOKING HAZARD — VEEV device and VEEV pods contain small parts.
- INGESTION HAZARD —If VEEV device or VEEV pods or their parts are swallowed, seek medical attention immediately due to risk of nicotine intoxication.

### **⚠ WARNING** Electrical and battery hazard

## Electrical Risks

Failure to follow these Safety Warnings and Instructions could result in fire, explosion, electric shock, injury, or damage to the product or other property:

- Do not use VEEV device where the use of electronic devices is prohibited.
- Do not charge or use VEEV device or accessories if damaged, tampered with or broken.
- Do not use VEEV device if its battery appears to be leaking.
- Only charge VEEV device using the USB Cable (supplied in the box) and a manufacturer-approved AC Power Adaptor (sold separately). Do not use third party accessories. Refer to 'Technical Data' section for details.
- Do not use, charge, or store VEEV device in places with high temperature (such as inside a car in summer, or near heat sources such as radiators or fireplaces).
- Do not use VEEV device where flammable materials, liquids and gasses are present.
- Never immerse or put VEEV device, its AC Power Adaptor or its USB Cable in contact with water and/or other liquids. Do not touch VEEV device and/or accessories if these become wet or immersed in any liquid.
- Never dispose of VEEV device with other household waste, as it may enter in contact with water and/or other liquids.
- Clean the USB charging port periodically to avoid accumulation of foreign matters (such as dust particles).
- Disconnect VEEV device and/or its accessories from any source of power if it overheats, fumes, ignites, or burns while charging.
- Do not touch VEEV device and/or its accessories if they overheat, fume, ignite, or burn.
- Handle with care. Do not drop VEEV device or subject it to strong shock.
- Do not attempt to open, service, modify or repair any



component of VEEV device or to replace any of the components or batteries.

### **Battery Risks**

VEEV device is powered with sealed Lithium-ion (Li-ion) batteries. Under normal conditions of use, the battery is sealed.

- If fluid from leaked battery is swallowed, seek medical attention immediately. Do not induce vomiting or ingest food or drink.
- If vapor from leaked battery liquid is inhaled, get fresh air and seek medical attention.
- If fluid from leaked battery is in contact with skin, wash hands and do not touch eyes.
- If fluid from leaked battery is in contact with eyes, immediately flush with running water for at least 15 minutes and seek medical attention immediately.

### **⚠ CAUTION Allergic reaction risk**

- Using VEEV device and VEEV pods could cause an allergic reaction, such as swelling of the face, lips, tongue, gums, throat, or body, difficulty breathing, or wheezing.
- Stop using VEEV device and VEEV pods and seek medical attention immediately if you experience any of the symptoms above as they may indicate a serious allergic reaction.

### **Exclusive Use of VEEV pods**

- Only purchase VEEV device and VEEV pods from your local or online VEEV stores or other authorized retailers.
- Only use VEEV pods with VEEV device. Never use VEEV device with other pods. Doing so may cause injury.
- Do not modify or attempt to refill VEEV pods in any way or add any substance to VEEV pods. Doing so may cause injury.

### **Storage**

- Do not expose this product to excessive heat or moisture.
- Store in dry ventilated premises within the temperature range of 0°C - 40°C, and air humidity 10-90%.
- The operating temperature of VEEV device falls within the range of 0°C - 40°C.

### **Reporting of adverse events or incidents**

- If you experience any unwanted health effect when using VEEV device, consult a health care professional.
- You can report any adverse event or incident directly by contacting your local Call Center (details can be found in the Customer Care & Warranty booklet). By reporting side effects, you can help provide more information on the safety of this product.
- For more information please go to [www.veev-vape.com](http://www.veev-vape.com).

## **TECHNICAL DATA**

### **VEEV Device Kit**

Electronic nicotine delivery system for multiple use with Bluetooth® technology  
Manufacturer: Philip Morris Products S.A., Quai Jeanrenaud 3, 2000, Neuchatel, Switzerland. Importer: Philip Morris Italia S.r.l, Via Po, 11-13-15, 00198 Roma, Italy.

### The kit includes:

#### VEEV Device

Model B-1603

Bluetooth 4.2

Battery type: Li-ion Rechargeable Battery  
(230 mAh)

Input: 5V  2A

Made in Malaysia

Month and year of production is indicated on the packaging

#### USB Cable Type C

Made in China

AC Power Adaptor is sold separately.

### Confirmation of Compliance

Hereby, Philip Morris Products S.A. declares that VEEV is in compliance with the essential requirements and other relevant provisions of Directive 2014/53/EU. The official Declaration of Conformity may be found at: [www.pmi.com/declarationofconformity](http://www.pmi.com/declarationofconformity)

VEEV device Model B-1603 operates within 2.402 – 2.480 GHz frequency band with a maximum RF output power below 10.0 dBm.



The Bluetooth® word mark and logos are registered trademarks owned by Bluetooth SIG, Inc. and any use of such marks by Philip Morris Products S.A. and its affiliates is under license. Other trademarks and trade names are those of their respective owners.

Further information regarding the firmware license for VEEV device is available on [www.veev-vape.com](http://www.veev-vape.com).

## INFORMATION ON DISPOSAL

VALID ACROSS ITALY



This symbol on the product or on its packaging indicates that this product and its individual parts (including batteries) must not be disposed together with your other household waste. Instead, you should dispose your used device by handing it over to a special drop-off depot for recycling of electric and electronic devices. Moreover, the waste equipment (including batteries) can be returned free of charge to the point of sale in case of the purchase of a new device or replacement of the same device in application of the warranty. The waste equipment can be returned in any case free of charge to points of sale where the sales area for electrical and electronic equipment (“EEE”) is larger than 400 square meters. Separate collection and disposal of used equipment (including batteries) helps to preserve nature resources and ensures protection of human health and the environment. Disposal of used equipment as unsorted household waste (for example, its burning or damping) may cause adverse consequences for the environment and human health. For more information about where you can drop off your waste equipment for recycling, please contact your local city office, your local household waste disposal service or the shop where you purchased the product. The local importer of the product will provide for the financing of the treatment and recycling of waste equipment returned through these designated collection points in accordance with local requirements.

E.E.E. Register no: IT1606000009351

## BATTERY REMOVAL INSTRUCTIONS (FOR DISPOSAL AND RECYCLING)

Batteries must not be removed by the consumer. Only an authorized recycler may safely remove batteries by following these steps.

VEEV Device Model B-1603:

Step 1: Check the voltage. The Device should be fully discharged before disassembling

it. Press the Power Button to check if all the LED lights are off; if not, the Device should be discharged until all the LED lights are off.

Step 2: Remove the End Cap Cover attached with adhesive.

Step 3: Remove two screws (Countersink K1.8, T6).

Step 4: Remove the End Cap Part.

Step 5: Remove the Connector Part away by pushing it from the bottom and gliding it out.

Step 6: Disconnect Battery Connector by lifting it up.

Step 7: Turn the Device around and Disconnect the Battery from its slot. Battery is attached with very firm double sided adhesive directly on the top of the PCB.

**Underage sale is prohibited. VEEV device should only be used with special replaceable VEEV pods (sold separately). Store in a place inaccessible for children. The voluntary warranty of the VEEV device and its elements present in the kit for defects in terms of materials or manufacture is one year from the date of purchase. Consult the “Voluntary Warranty” leaflet for more information. The rights conveyed under this voluntary warranty are in addition and without prejudice to all rights and remedies provided by consumer protection laws in the country of purchase.**

© 2019 Copyright Philip Morris Products S.A.